

C-168 - 155

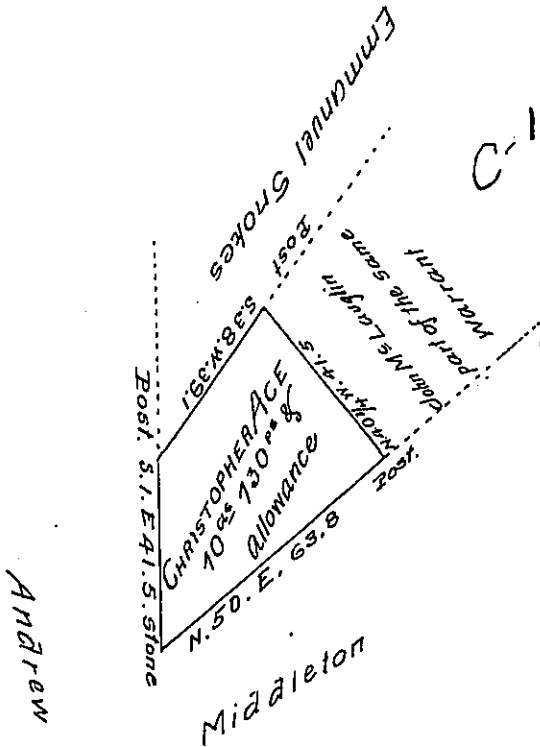

*Draught of a Tract of land situate in Mifflin Township Cumberland  
 County containing 10<sup>ac</sup> 130<sup>ps</sup> & allowance &c. Surveyed February  
 6<sup>th</sup> 1854 in pursuance of a Warrant granted to Daniel McLaughlin  
 dated January 23<sup>d</sup> 1775*

*Abm Lamberton*

*County Surveyor*

*To J Porter Brawley Esq.  
 Surveyor General*

*IN TESTIMONY that the above is a copy of the original remaining on file in  
 the Department of Internal Affairs of Pennsylvania, made  
 conformably to an Act of Assembly approved the 16th day of  
 February 1833, I have hereunto set my hand and caused  
 the Seal of said Department to be affixed at Harrisburg,  
 this third day of November 1907*

*Henry Howell*  
 Secretary of Internal Affairs.